

Installation Instructions

1. Loosen strut bolts, but do not remove.
2. On front lower side of strut remove OE strut bolt and discard.
3. Install shim with thick side to the bottom (to decrease Camber) (See Illustration).
4. Install new 30mm bolt provided with kit- to the thick end of the shim (Note: add Loctite on new bolts)
5. Snug bolts at this time but do not tighten.
6. Repeat steps on rear side of strut.
7. Torque all strut bolts to manufacturing specification.
8. Finish alignment and road test.

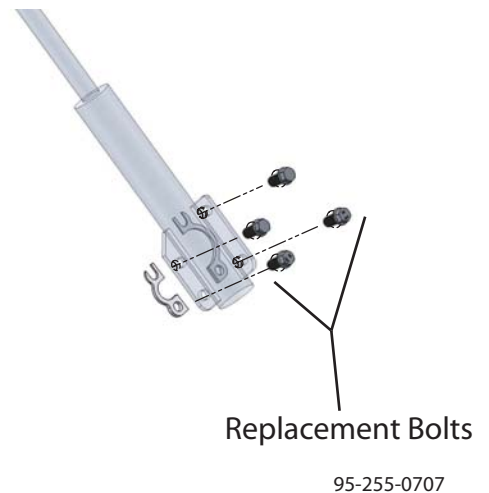

Installation Instructions

1. Loosen strut bolts, but do not remove.
2. On front lower side of strut remove OE strut bolt and discard.
3. Install shim with thick side to the bottom (to decrease Camber) (See Illustration).
4. Install new 30mm bolt provided with kit- to the thick end of the shim (Note: add Loctite on new bolts)
5. Snug bolts at this time but do not tighten.
6. Repeat steps on rear side of strut.
7. Torque all strut bolts to manufacturing specification.
8. Finish alignment and road test.

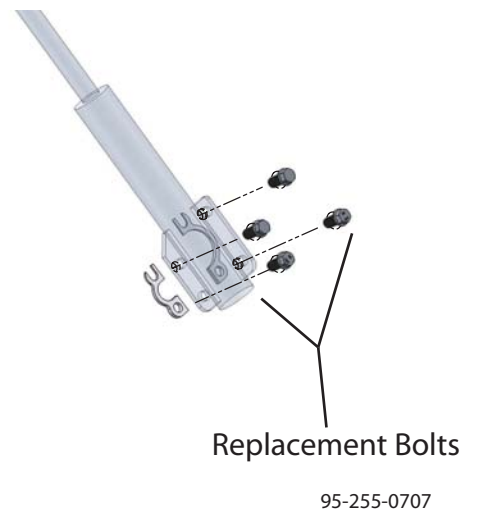

Installation Instructions

1. Loosen strut bolts, but do not remove.
2. On front lower side of strut remove OE strut bolt and discard.
3. Install shim with thick side to the bottom (to decrease Camber) (See Illustration).
4. Install new 30mm bolt provided with kit- to the thick end of the shim (Note: add Loctite on new bolts)
5. Snug bolts at this time but do not tighten.
6. Repeat steps on rear side of strut.
7. Torque all strut bolts to manufacturing specification.
8. Finish alignment and road test.

