

## DRIVELINE ANGLE CAM BOLT

Installing any aftermarket lift kit will drastically change driveline angle.

On a 1998 or newer Jeep Wrangler the upper control arm bracket on the rear axle has embossed templates, designed to be cut out to allow installation of cam bolts for driveline angle adjustment. See Figure 1.

To properly measure and adjust driveline angle, consult the manufacturer's service manual. See Figure 2

NOTE: When re-installing the upper suspension arm, the bracket for the parking brake cable must face inboard. See Figure 1.

CAUTION: All control arm bushings and fasteners must be tightened at curb height. Failure to do so will result in a harsh ride and reduced bushing life.

Torque Specifications: 75NM or 55 ft. lbs.

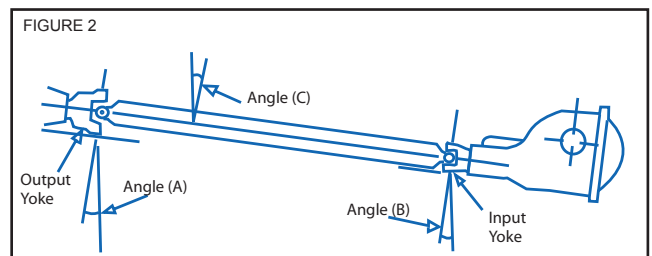
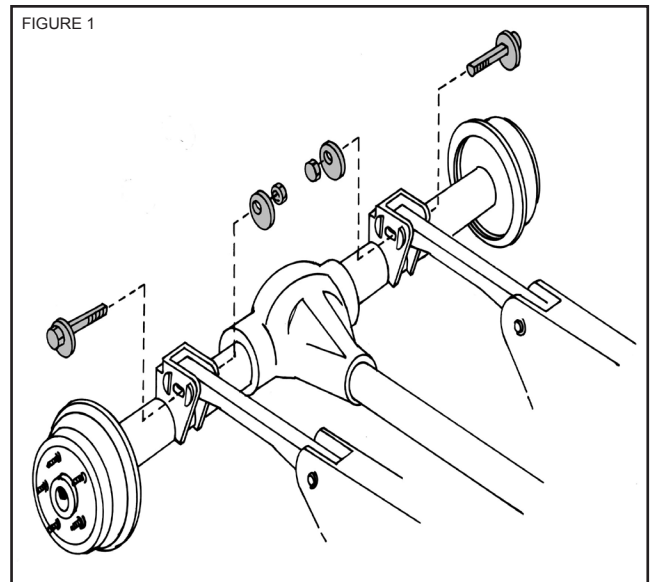

95-257-1207

## DRIVELINE ANGLE CAM BOLT

Installing any aftermarket lift kit will drastically change driveline angle.

On a 1998 or newer Jeep Wrangler the upper control arm bracket on the rear axle has embossed templates, designed to be cut out to allow installation of cam bolts for driveline angle adjustment. See Figure 1.

To properly measure and adjust driveline angle, consult the manufacturer's service manual. See Figure 2

NOTE: When re-installing the upper suspension arm, the bracket for the parking brake cable must face inboard. See Figure 1.

CAUTION: All control arm bushings and fasteners must be tightened at curb height. Failure to do so will result in a harsh ride and reduced bushing life.

Torque Specifications: 75NM or 55 ft. lbs.

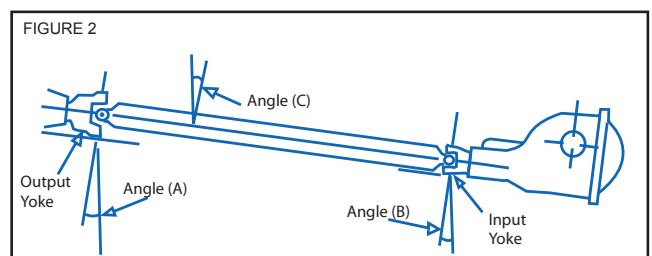
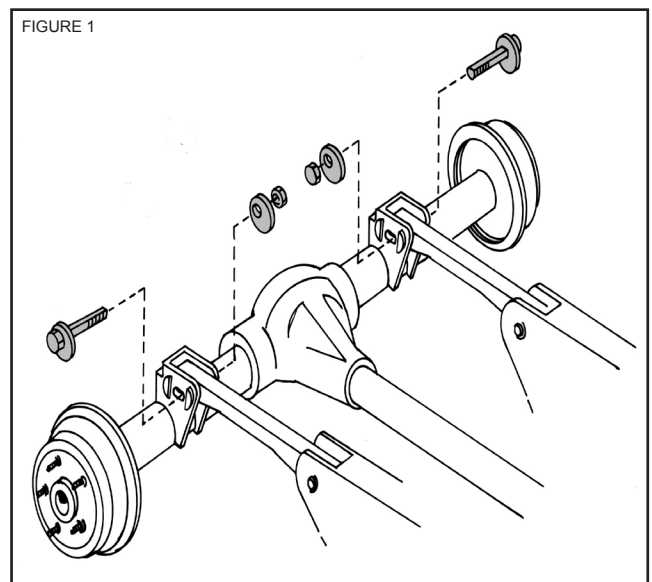

95-257-1207